

# HERMITAGE PARISH COUNCIL

Clerk to Hermitage Parish Council  
Farm Gate  
High Street  
Chieveley  
RG20 8TA  
Email: [hermitagepc@outlook.com](mailto:hermitagepc@outlook.com)  
07827974767

Chairman Mrs Sue Russell

## Request for quotation or tender

13<sup>th</sup> October 2022

Preparation and construction of shed foundation and soak-away as described below including laying a French drain from roof guttering fall pipe to soak-away, drain to distribute rain water run-off to complete width of soak-away..

### Erection of metal shed adjacent to Hermitage Parish Council MUGA located on Playing Field:

#### 1. Foundation:

Location as on attached indicative sketch plan below (do not scale drawing):

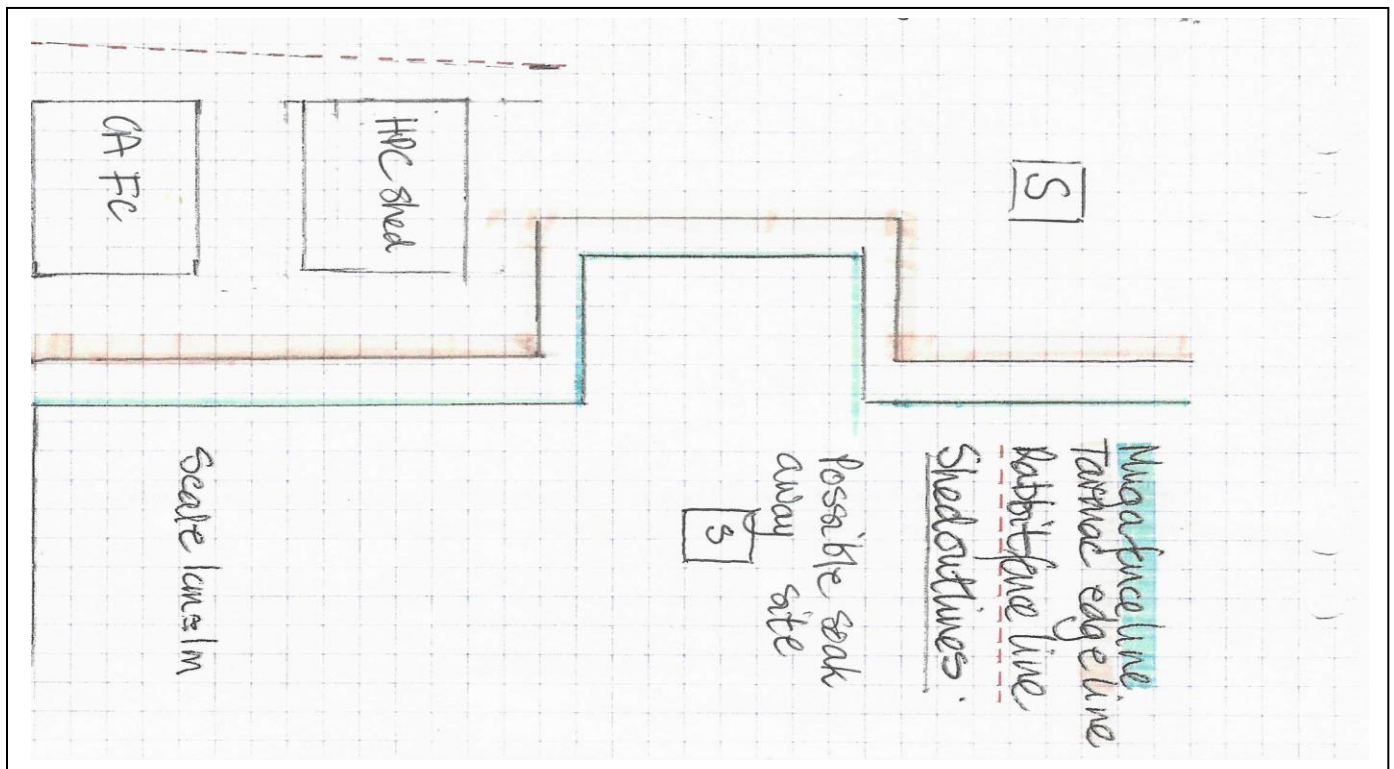

- Measurements of foundation 3.01 metres by 2.21 metres (shed dimensions 2.61 metres x 1.81 metres external).

- Excavate the ground to a depth of approximately 200 mm.
- Backfill the excavation to a depth of approx. 125 mm with so called "50 mm down (2 inch down)" stone hard-core rubble.
- Blind the rubble surface with builder's sand.
- Cover this surface with 1000 grade black Visqueen DPC polythene sheet
- Fill on top with 100/125 mm (minimum thickness) of hand or cement-mixer mixed concrete (standard concrete mix ratio of **1 part cement to 5 parts ballast (aggregate and sand)**)

NOTE: Use timber shuttering around the foundation and raise the surface approx. 25 mm minimum above the adjacent field surface level to allow for water on the field to run away and not enter into shed floor area.

**2. Erection of Shed (see APPENDIX 1, p.2 below):**

- Manufacturers suggest this should take 2 people 3 -4 hours.
- Location is as on attached sketch plan, and as shown in Section 1 of this document (above).
- Shed should be securely bolted to foundation once concrete has set firm using suitable Rawl-bolts at each corner of the shed frame.

**3. Soak away:**

- Choose and mark-out location of soak away. This should be sited more than 5m from the village hall building , the Multi-use Games Area surface and adjacent roadways and must not be within 2.5m of a boundary or in an area of unstable land in ground where the water table reaches the bottom of the soak away at any time of the year. Position chosen for the soak-away must be approved by the Parish Clerk before work commences.
- Excavate 1 x 1 x 1 metre cube of soil and fill with 50 mm down hard-core rubble. This hole in the ground and when back-filled with rubble, which must have enough voids in it to absorb large volumes of water and yet be strong enough to be covered over so that surface strength of the playing field is maintained. Retain top surface turf for re-use to cover soak-away.
- Excavate a trench from location of roof guttering rain water fall pipe to contain French drain. Retain top surface turf for reuse when back filling.
- Connect soak-away to the roof rain water guttering fall pipe via a French drain (pre-perforated plastic drainpipe), ensuring this French drain covers the full width of the soak-away surface and is a good water tight connection to guttering fall pipe.
- Back fill trench around French drain with gravel.
- Relay top surface turf, using it to cover soak-away and drain trench then make good all edges, etc.

**Delivery address or location of works:** Hermitage Village Hall Playing Field adjacent to MUGA at rear of Village Hall.

**Tenders to be returned to:** Parish Clerk, as above with copy to chairman,

**Tenders are to be delivered:** within seven days of the date of this enquiry as above.

Hermitage Parish Council will acknowledge the receipt of your quotation or tender within 7 days of receipt and inform you of the likely decision date at the same time.

APPENDIX 1:

**Proposed Shed**

[Portland Apex Metal Shed - Garden Buildings Direct](#)

Dimensions (do not scale drawing):

